

Swing Check Valve Class 300

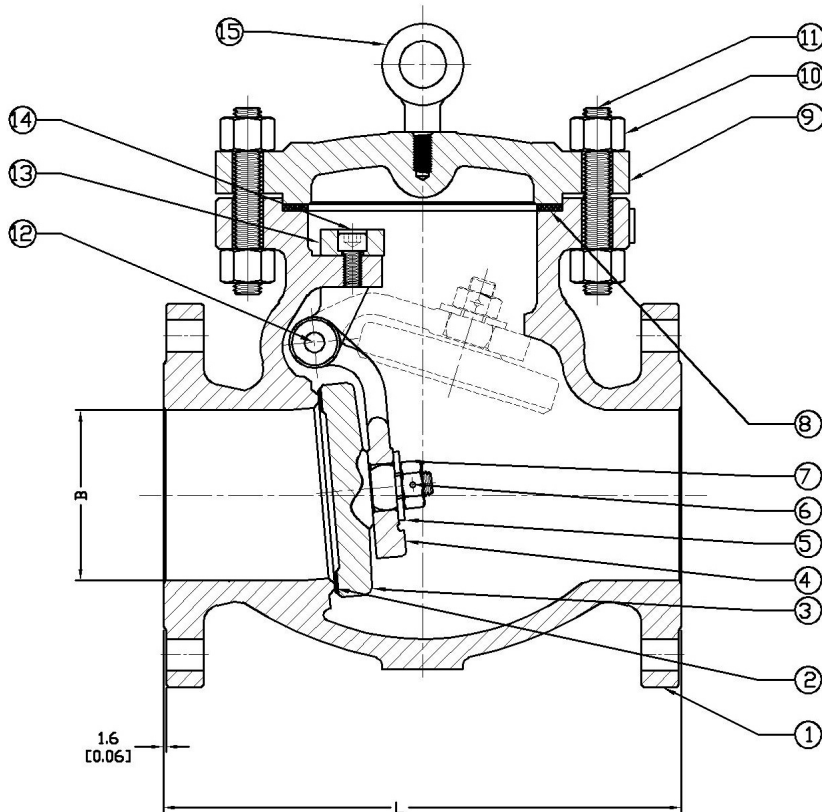

Standards:

Face to Face Dimensions: ANSI B16.10
 End Flange Dimensions: ANSI B16.5
 Basic Design: ASME B16.34
 Test Standard: API 598

MATERIAL LIST

NO.	Part Name	ASTM Specification (Specs – Grades/Types)	
		A351	A351
		CF8 (304)	CF8M (316)
1	Body	A351-CF8	A351-CF8M
2	Seat-Integral	A351-CF8	A351-CF8M
3	Disc	A182-F304	A182-F316
4	Swing Arm	A351-CF8	A351-CF8M
5	Washer	A276-316	A276-316
6	Pin	A276-316	A276-316
7	Hex Nut	A194-8	A194-8
8	Gasket	304/Graphite	316/Graphite
9	Cover	A351-CF8	A351-CF8M
10	Body Nut	A194-8A	A194-8A
11	Body Stud	A193-B8M	A193-B8M
12	Hinge Pin	A193-B8M	A193-B8M
13	Hinge Plate	A351-CF8	A351-CF8M
14	Bolt	A194-8A	A194-8A
15	Lifting Eye (6" and larger)	Carbon Steel	Carbon Steel

NOTE: Seat rings on valves less than 2 NPS are swedged into the valve body.
 10 & 12" valves feature an external access hinge pin.

DIMENSIONS AND WEIGHTS

Size	NPS	1/2	3/4	1	1-1/2	2	2-1/2	3	4	5	6	8	10	12
L (RF)	In	6.00	7.00	8.50	9.50	10.50	11.50	12.50	14.00	15.75	17.50	21.00	24.50	28.00
	Mm	152	178	216	241	267	292	318	356	400	444	533	622	711
L (RTJ)	In	6.42	7.50	9.00	10.00	11.13	12.13	13.13	14.63	16.38	18.13	21.63	25.13	28.63
	Mm	163	191	229	254	283	308	333	371	416	460	549	638	727
L (BW)	In	6.00	7.00	8.50	9.50	10.50	11.50	12.50	14.00	15.75	17.50	21.00	24.50	28.00
	Mm	152	178	216	241	267	292	318	356	400	444	533	622	711
B	In	0.50	0.75	1.00	1.50	2.00	2.50	3.00	4.00	5.00	6.00	8.00	10.00	12.00
	Mm	12.7	19.1	25.4	38.1	51	63.5	76	102	127	152	203	254	304
WT	LB	10.58	19.4	21.16	39.24	41.88	61.75	79.50	119.0	174.0	223.0			
	KG	4.8	8.8	9.6	17.8	19.0	28.0	36.0	54.0	79.0	101.0			