

# Swing Check Valve Standard

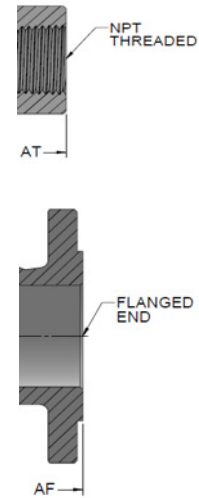
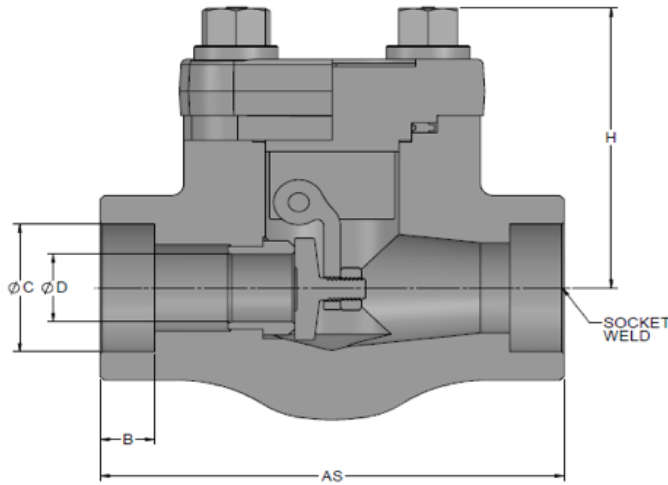

## 504 Series: Bolted Bonnet

STANDARDS				
DESIGN:	API 602	TESTING:	API 598	
	MSS SP-118		CONNECTIONS:	NPT - ASME B1.20.1
	ASME B16.34			SW - ASME B16.11
	FACE TO FACE-ASME B16.10			BW- ASME B16.25
PRESSURE CLASS:	NPT, SW & BW - 800, 1500	FLANGED - ASME B16.5		
	FLANGED - 150, 300, 600, 1500			

DIMENSIONS														WGT.(lb/kg)					
SIZE		AT/AS 800	AF - 150	AF - 300	AF - 600	B (Min)	C (Min)	D(Min)- NPT/SW	D(Min)-RF 150	D(Min)-RF 300/600	H-NPT/ SW(504)	H-RF(150)	H-RF(300)	H-RF(600)	150 (504)	300 (504)	600 (504)	800 (504)	
1/4	Inch	3.11	/	/	/	0.39	0.56	0.30	/	/	2.28	/	/	/	/	/	/	/	3.09
	mm	79.0	/	/	/	10.0	14.2	7.5	/	/	58.0	/	/	/	/	/	/	/	1.4
3/8	Inch	3.11	/	/	/	0.39	0.69	0.39	/	/	2.28	/	/	/	/	/	/	/	3.09
	mm	79.0	/	/	/	10.0	17.6	10	/	/	58.0	/	/	/	/	/	/	/	1.4
1/2	Inch	3.11	4.25	5.98	6.50	0.39	0.86	0.51	0.39	0.39	2.28	2.20	2.20	2.28	4.41	6.17	7.05	2.87	
	mm	79.0	108.0	152.0	165.0	10.0	21.8	13.0	10.0	10.0	58.0	56.0	56.0	58.0	2.0	2.8	3.2	1.3	
3/4	Inch	3.62	4.61	7.01	7.48	0.51	1.07	0.51	0.49	0.51	2.28	2.20	2.28	2.28	5.73	8.82	9.48	3.31	
	mm	92.0	117.0	178.0	190.0	13.0	27.2	13.0	12.5	13.0	58.0	56.0	58.0	58.0	2.6	4.0	4.3	1.5	
1	Inch	4.37	5.00	8.50	8.50	0.51	1.33	0.71	0.71	0.71	2.95	2.95	2.95	2.95	9.26	13.45	14.33	5.95	
	mm	111.0	127.0	216.0	216.0	13.0	33.9	18.0	18.0	18.0	75.0	75.0	75.0	75.0	4.2	6.1	6.5	2.7	
1-1/4	Inch	4.72	5.51	9.02	9.02	0.51	1.68	0.94	0.94	0.94	3.27	3.27	3.27	3.27	13.45	17.64	18.74	8.16	
	mm	120.0	140.0	229.0	229.0	13.0	42.7	24.0	24.0	24.0	83.0	83.0	83.0	83.0	6.1	8.0	8.5	3.7	
1-1/2	Inch	4.72	6.50	9.49	9.49	0.51	1.92	1.14	1.14	1.14	3.70	3.70	3.82	3.82	16.31	24.25	27.12	9.70	
	mm	120.0	165.0	241.0	241.0	13.0	48.8	29.0	29.0	29.0	94.0	94.0	97.0	97.0	7.4	11.0	12.3	4.4	
2	Inch	5.51	7.99	10.51	11.50	0.65	2.41	1.44	1.44	1.44	4.21	4.49	4.53	4.53	28.66	35.49	38.80	14.33	
	mm	140.0	203.0	267.0	292.0	16.5	61.2	36.5	36.5	36.5	107.0	114.0	115.0	115.0	13.0	16.1	17.6	6.5	

DIMENSIONS-1500											WGT.(lb/kg)	
SIZE		AT/AS (504)	AF (504)	B (Min)	C (Min)	D (Min)-NPT/SW	D (Min)-RF (504)	H -NPT/SW (504)	H-RF (504)	RF (504)	NPT/SW (504)	
1/2	Inch	4.37	8.50	0.39	0.86	0.51	0.39	2.95	2.95	13.23	6.17	
	mm	111.0	216.0	10.0	21.8	13.0	10.0	75.0	75.0	6.0	2.8	
3/4	Inch	4.37	9.02	0.51	1.07	0.51	0.51	2.95	2.95	16.53	5.95	
	mm	111.0	229.0	13.0	27.2	13.0	13.0	75.0	75.0	7.5	2.7	
1	Inch	4.72	10.00	0.51	1.33	0.71	0.71	3.27	3.27	26.01	9.04	
	mm	120.0	254.0	13.0	33.9	18.0	18.0	83.0	83.0	11.8	4.1	
1-1/4	Inch	4.72	/	0.51	1.68	0.94	/	3.70	/	/	10.58	
	mm	120.0	/	13.0	42.7	24.0	/	94.0	/	/	4.8	
1-1/2	Inch	5.51	12.01	0.51	1.92	1.14	1.14	4.21	5.31	52.91	16.09	
	mm	140.0	305.0	13.0	48.8	29.0	29.0	107.0	135.0	24.0	7.3	
2	Inch	6.30	14.49	0.65	2.41	1.44	1.44	5.12	6.50	89.95	26.90	
	mm	160.0	368.0	16.5	61.2	36.5	36.5	130.0	165.0	40.8	12.2	